

FIRST FLOOR PLAN

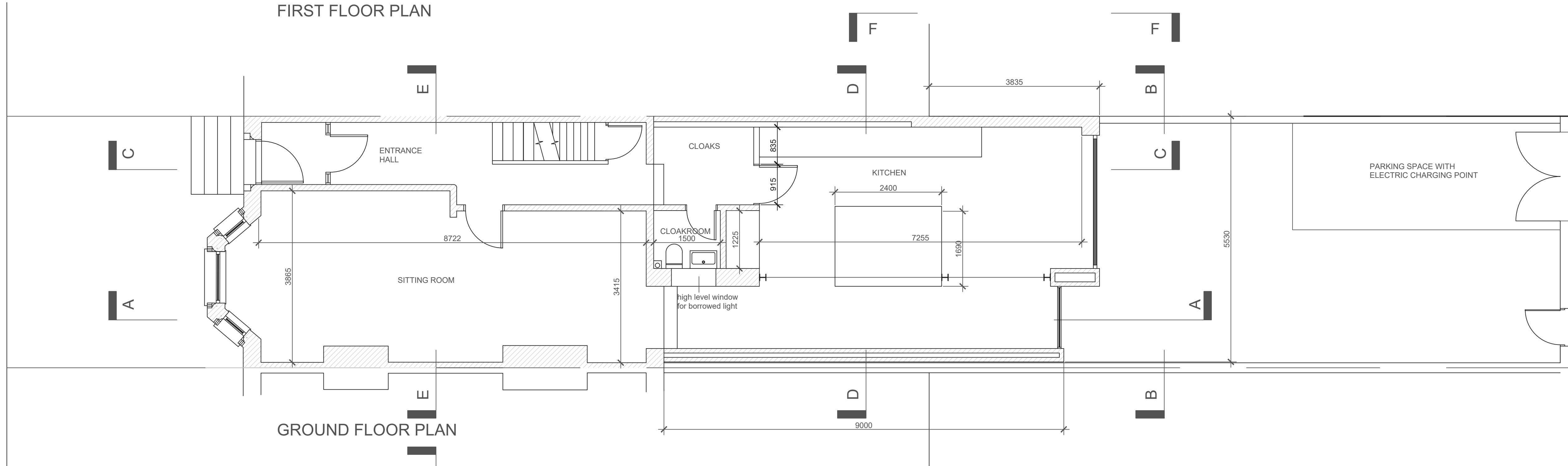

GROUND FLOOR PLAN

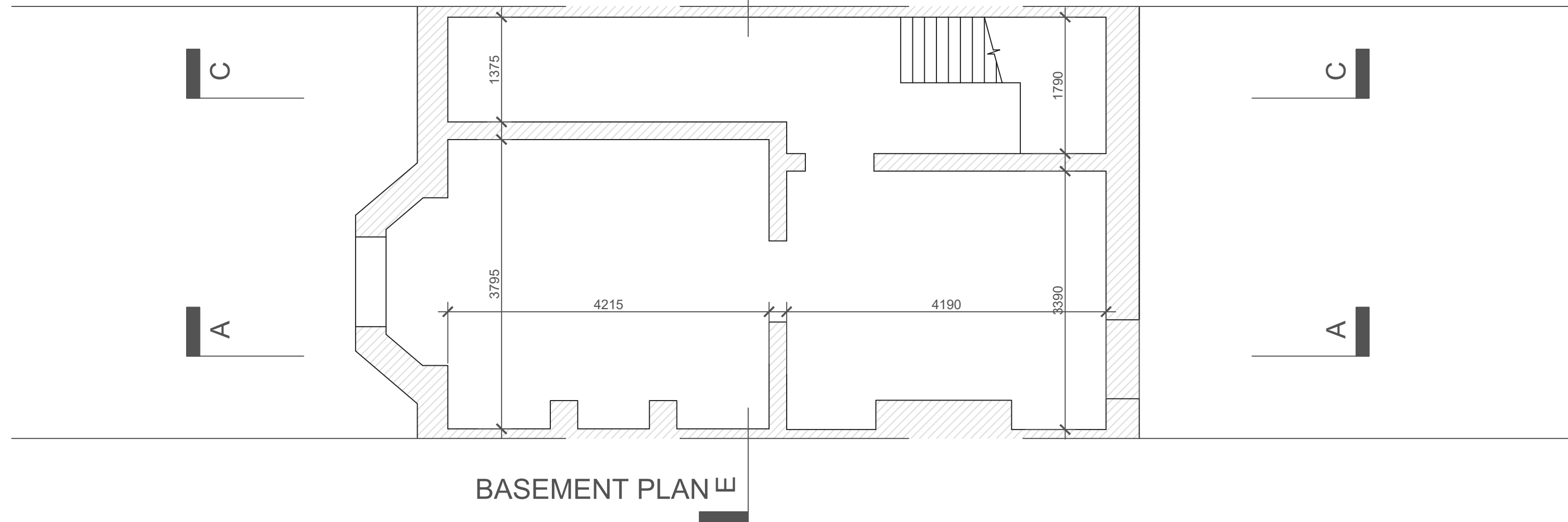

BASEMENT PLAN



All dimensions are in millimetres  
All dimensions to be checked on site  
© WPB Associates

Mike Wilton, Architect 7 Almond Close Lytham St Annes, FY8 2FD  Tel: 07957 404603  Project Address: 21 Cleveland Road, Lytham St Annes, FY8 5JH	Project: Alterations and Repairs to 2 Storey Rear Extension and New Side Infill Rear Extension		
	Date: 27 June 2022	Job no: 21186	Drawing no: PP2-001
	Scale: 1:50 @ A1 1:100 @ A3	Revision: C	Drawn: MW
	Description: Proposed Floor Plans		