

PROPOSED GROUND FLOOR PLAN

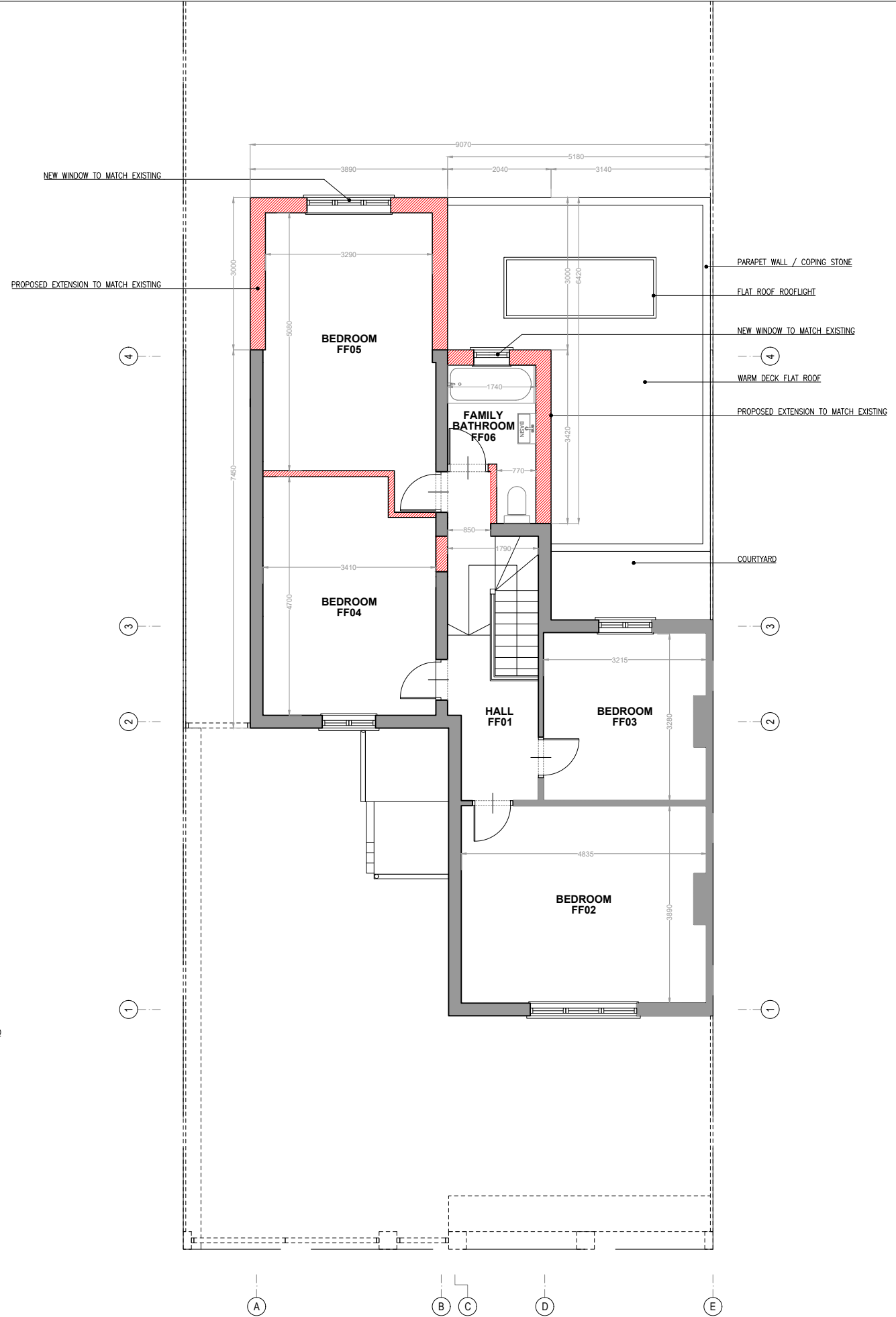

PROPOSED FIRST FLOOR PLAN

REFERENCE:
4WR

DRAWING NO:
A_4WR_HH1_PR_200A

DRAWING TITLE:
PROPOSED FLOOR PLANS

PROJECT:
**4 WESTBURY ROAD,
LONDON, E7 8BU**

General Notes:

- Not for Construction.
- All design based on survey and drawings provided by the client.
- Drawings are indicative and for information only.
- All dimensions to be checked on site prior to construction or fabrication.
- Do not scale from this drawing. Any discrepancies should be reported to the architect.
- Where structural elements are shown this is for illustrative purposes only.
- All structural design to be carried out by suitable qualified structural engineer.
- All work must comply with relevant British Standard and Building Regulations requirements.
- All drawings are to be read in conjunction with specifications and drawings of all other consultants.

This Drawing is Copyright

KEY:

EXISTING STRUCTURE

REVISION:

DATE:

0
A

06.08.2022
31.08.2022

DRAWING SCALE:

1:50 @ A3
1:100 @ A3

0 1 2 3 4 5 M

STATUS:

SCALE:

PLANNING

1:100 / A3 PRINT

DATE:

DRAWER:

31.08.2022

MA

AKITAKOMARARCHITECTS

TEL:

E-MAIL:

07481224702

studio@akitakomararchitects.com

WEB:

www.akitakomararchitects.com

CLIENT:

ABDUL TAILOR