

01634 37 37 37 | sales@jacksonsproperty.co.uk
01634 37 37 38 | lettings@jacksonsproperty.co.uk

JACKSONS

jacksonsproperty.co.uk

f jacksonsrainham

@JacksonsRainham



15 Houghton Avenue, Gillingham, ME7 3RY

Offered With No Onward Chain This Generous Property Could Be Your Forever Home.

In need of some updating the property is perfectly liveable making it the perfect base for any family wanting to make this their forever home. Boasting well proportioned accommodation, a good size rear garden and an enviable postcode it's sure to attract interest.

- Generous Family Home
- 5 Bedrooms
- Lovely Size Garden
- Double Garage & Driveway
- Popular Location
- Viewing Recommended

£600,000 Freehold

15 Houghton Avenue

Hempstead, Gillingham, ME7 3RY



Entrance Hall

Lounge
18'2 x 16'9 (5.54m x 5.11m)

Kitchen
12'4 x 10'1 (3.76m x 3.07m)

Dining Room
11'9 x 11 (3.58m x 3.35m)

Office/Bedroom
11 x 7'5 (3.35m x 2.26m)

W.C.

Bedroom 1
14 x 11 (4.27m x 3.35m)

En-Suite
7'5 x 4'1 (2.26m x 1.24m)

Bedroom 2
14'8 x 9'2 (4.47m x 2.79m)

Bedroom 3
11'8 x 11 (3.56m x 3.35m)

Bedroom 4
9'7 x 7'9 (2.92m x 2.36m)

Bathroom
6'7 x 5'10 (2.01m x 1.78m)

Double Garage & Drive

Front & Rear Gardens

Agents Note

VIEWING ARRANGEMENTS
Strictly by prior appointment with Jacksons on
01634 37 37 37

TENURE
Freehold

MEASUREMENTS

All Measurements Are Approximate. These sales particulars have been prepared by Jacksons Estate Agents upon the instructions of the vendor(s). Services, fittings and equipment referred to within the sales particulars have not been tested and no warranties can be given. Accordingly the prospective buyer(s) must make their own enquiries regarding such matters.

ADDITIONAL SERVICES

To enable you to budget for your move, we are able to provide you with a complete breakdown of all expenses associated with moving, including legal fees, survey fees, early repayment charges, removal fees and all aspects of mortgage charges.

Ground Floor



1st Floor

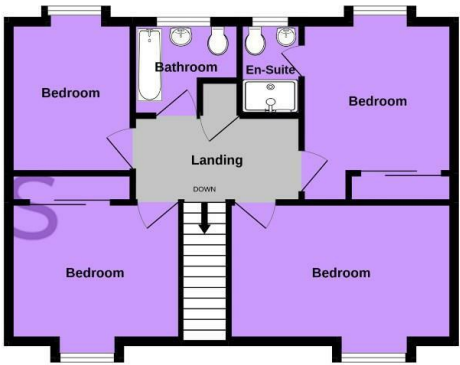

Whilst every attempt has been made to ensure the accuracy of the floorplan contained here, measurements of doors, windows, rooms and any other items are approximate and no responsibility is taken for any error, omission or mis-statement. This plan is for illustrative purposes only and should be used as such by any prospective purchaser. The services, systems and appliances shown have not been tested and no guarantee as to their operability or efficiency can be given.
Made with Metropix ©2022

These particulars, whilst believed to be accurate are set out as a general outline only for guidance and do not constitute any part of an offer or contract. Intending purchasers should not rely on them as statements of representation of fact, but must satisfy themselves by inspection or otherwise as to their accuracy. No person in this firms employment has the authority to make or give any representation or warranty in respect of the property.

