

# Slab Construction Layout

New slab construction with pipes to be laid on insulation with screed over

New aluminium slim profile sliding doors with floor recessed track. Typically 2m x 2.1m panels. Frame colour: Dark grey

New two-storey pitched roofed extension. External insulated render Colour: white

Manifold to be located here

**U Values**  
External Walls = 0.18 W/m2K  
Floor = 0.18 W/m2K (new areas)  
Roof = 0.15 W/m2K  
Windows = 0.83 W/m2K  
Doors = 0.72 W/m2K

MVHR throughout

GROUND FLOOR PLAN (1:50)

Terrace

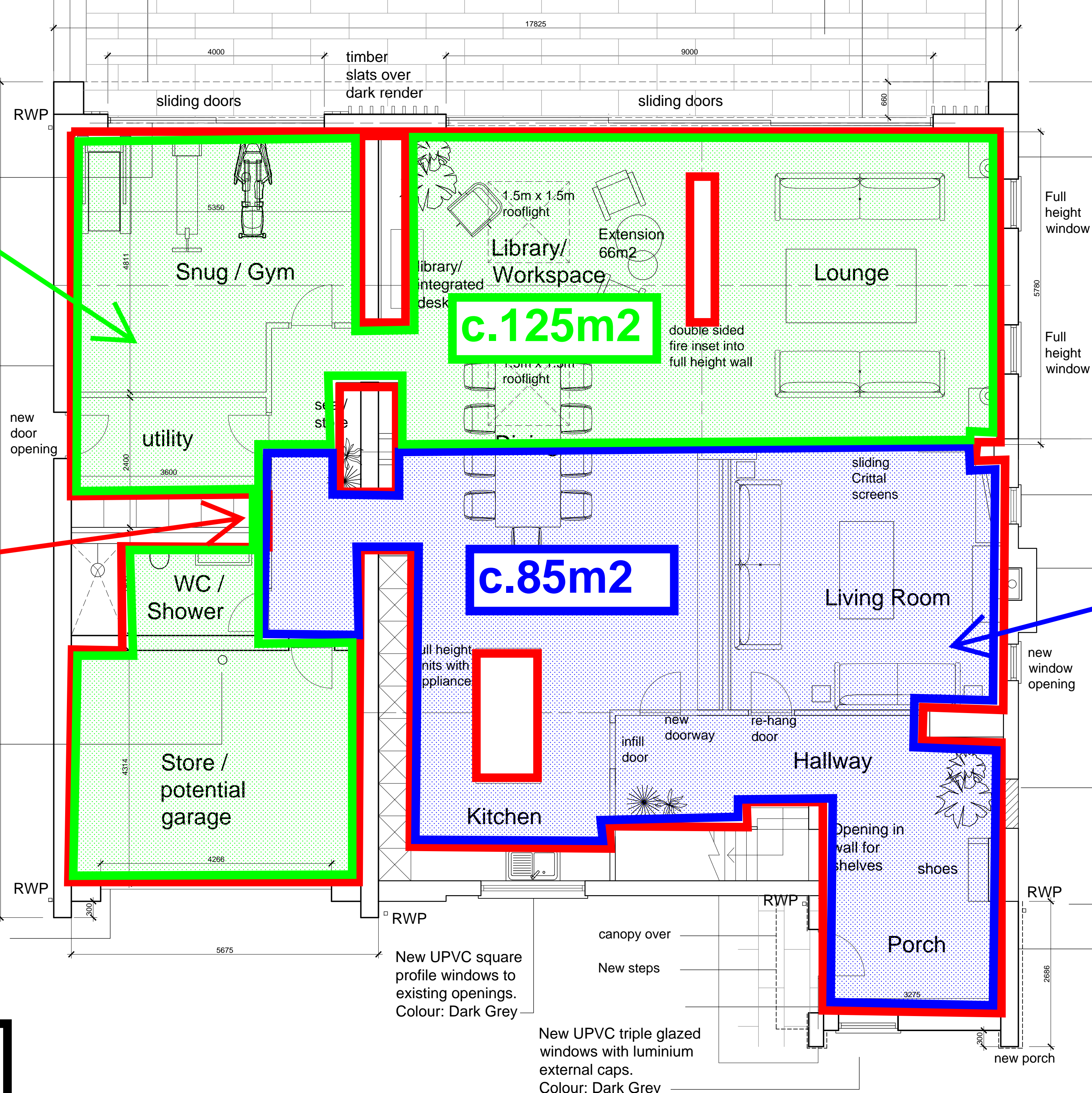

Indicative terrace with natural stone paving or external grade tiles

New aluminium slim-profile sliding doors with floor recessed track. Typically 3m x 2.1m panels. Frame colour: Dark Grey

New single-storey flat roofed extension. External insulated render Colour: white

New UPVC square profile windows to existing openings. Colour: Dark Grey

Existing window opening with new UPVC square profile windows to existing openings. Colour: Dark Grey

Existing brickwork retained

Existing WC window removed and bricked up. Brick bond to match existing

New UPVC square profile RWP and gutters to Colour: Dark Grey

Existing porch removed and new two-storey extension to similar footprint added. Brickwork to ground floor and externally insulated render to first floor. Colour: white

New UPVC triple glazed windows with luminium external caps. Colour: Dark Grey

CLIENT

MR W. CHAMBERS

STRUCTURAL ENGINEER

SERVICES ENGINEER

CONSULTANT

KEY PLAN

NOTES:

DO NOT SCALE. FIGURED DIMENSIONS ONLY TO BE TAKEN FROM THIS DRAWING. CHECK DIMENSIONS ON SITE AND REPORT DISCREPANCIES TO THE ARCHITECT.

THIS DRAWING IS PROTECTED BY COPYRIGHT.

ALL AREAS HAVE BEEN MEASURED FROM CURRENT DRAWINGS. THEY MAY VARY BECAUSE OF (EG) SURVEY, DESIGN DEVELOPMENT, CONSTRUCTION TOLERANCES, STATUTORY REQUIREMENTS OR RE-DEFINITION OF THE AREAS TO BE MEASURED.

Existing none insulation ground floor slab. Low profile system to be laid on top of slab

13	06.04.23	Issued for planning	DJW	A.J.L.
Two storey extension set back to existing building line at front.				
First floor extension set back 700mm at rear				
12	27.01.23	Issued for planning	DJW	A.J.L.
11	24.11.22	Issued for pre-app planning	DJW	A.J.L.
P5	21.11.22	Existing WC window removed and bricked up	AY	A.J.L.
P4	18.11.22	Issued following client comments. Windows to side elevation amended	AY	A.J.L.
P3	01.11.22	Issued following client comments	AY	A.J.L.
P2	28.09.22	Preliminary Issue	AY	A.J.L.
P1	10.08.22	Preliminary Issue	AY	A.J.L.
Rev.	Date	Comment	Drawn	Checked

Issue Purpose

INFORMATION

tp bennett

Royal Mills Unit 2B 17 Redhill Street Manchester M4 5BA | +44 (0)161 694 7700 | www.tpbenett.com

Project  
CEDARWOOD ALTERATIONS AND EXTENSION. 4 HAMPTON GROVE STOURBRIDGE DY7 6LP

Drawing Title  
PROPOSED GROUND FLOOR PLAN

Drawn	Date	Scale	Alt. Ref.
AY	08/08/2022	@ A1 1:50	
tp bennett Project No.	Drawing Number	Rev	
T8185	D 2100	I3	